

CRUISE

WEEKLY



Thursday 13 Jul 2017

Cruise Weekly today

Cruise Weekly today features four pages of all the latest cruise industry news.

CLIA appoint ops mgr

CRUISE Lines International Association (CLIA) Australasia has appointed Melissa Juelich as membership operations manager.

Juelich has worked for CLIA in a temporary capacity last year and replaces Amanda Rixon, who departed CLIA Australasia earlier this month after five years.

She was most recently network communications coordinator at Helloworld Travel & has worked at Emirates, South Africa Tourism, AFTA and United Travel NZ.

CLIA Australasia md Joel Katz said: "We are delighted to have Melissa back on board to support our members as we continue to grow our membership activities and engagement in both Australia and New Zealand".

Cairns port expansion

CAIRNS is set to lure more cruise ships to the region following a dedication of \$30m from the Queensland Govt over the next two financial years to Ports North's \$120 million Cairns Shipping Development Project.

The scheme involves widening and deepening the existing navigation channel to allow larger cruise ships to berth at the Cairns Cruise Liner Terminal.

It would allow for ships up to 300m long to berth and is forecast to attract an additional 70 cruise ships (with homeporting and the Brisbane Cruise terminal) through the Port of Cairns each year by 2031.

Carnival Australia executive chairman, Ann Sherry said the plan would help Cairns realise its full potential as a major cruise hub, noting "We have always seen Cairns as a cruising hotspot with great potential".

"This project is key to turning that potential into a reality with all the benefits that the \$4.6 billion Australian cruise tourism industry has to offer Cairns and the region in terms of visitor spending and opportunities for local businesses," she said.

Queensland Minister for State Development Anthony Lynham said "Ports North last year revised the project to cap proposed expanded capacity at ships up to 300 metres in length that now anchor offshore as they cannot berth in the port."

Lynham said the revision reduced the volume of dredging needed from more than four million to just one cubic metre, ensuring minimum disruption to the Great Barrier Reef.

This week the revised draft Environmental Impact Statement for the plan opened up for public comment until 25 Aug.

Events on Explorer

P&O Cruises is highlighting *Pacific Explorer's* suitability for corporate groups, with bookings available on the vessel's year-round cruises from Sydney.

The Marquee Showlounge, which by night hosts two stage shows, is the ship's largest conference space accommodating 540 guests and also has a second theatre, Black Circus.

Corporate groups sales manager for the brand, Rebecca Mutanen said *Explorer* "had all the right ingredients" for a conference, meeting or incentive at sea.

"P&O's sister ships *Pacific Eden* and *Pacific Aria* offer three dedicated conference venues whilst *Pacific Explorer* has two large theatres and smaller venues making her ideal for flexible conferences," she said

Mutanen added *Explorer* is also suitable for incentives, and several large organisations had secured their cruise for next year.

BOOK BEFORE 17 JULY!

NORWEGIAN JEWEL SPECIAL OFFER

Up To US \$3,300 In Overall Value

CHOOSE UP TO

UP TO

5 FREE + US\$500

OFFERS*

ONBOARD SPEND*

Balconies & above

Plus Reduced Deposits*



NCL NORWEGIAN *Feel Free*
CRUISE LINE®

CLICK HERE FOR MORE DETAILS OR CALL 1300 255 200

*Offers correct as at 10 July 2017 and are subject to change or withdrawal. Combination of offers ends 17 July 2017 unless extended. For full terms & conditions, visit ncl.com.au.

CRUISE



WEEKLY



Thursday 13 Jul 2017

Find out the latest results of the cruise survey in the July issue of *travelBulletin*.

CLICK to read
travelBulletin

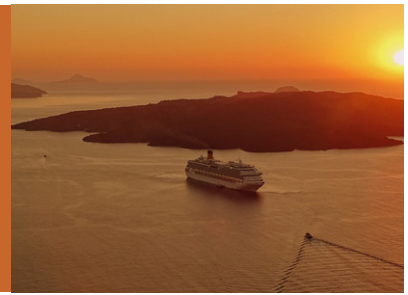

More CLIA Cruise360 details

PHIL Hoffmann Travel founder Phil Hoffmann has been confirmed as one of the key presenters at the upcoming Cruise360 conference, to be hosted in Sydney next month by Cruise Lines International Association Australasia.

Hoffmann will lead one of the four Masterclasses during the conference, speaking on *Driving Loyalty - How to Differentiate Your Agency and Leverage Your Loyal Clients*, providing "practical examples and firsthand experiences to reveal how to generate loyalty amongst your customers and as a result grow your business".

Other speakers will include Jan Swartz, group president of Princess Cruises and Carnival Australia, who will provide *A Peek into the Future of Cruise Guest Experience* - addressing the evolution of today's on board offerings and how cruise-focused

agents can make the most of the ongoing changes.

Twitter fanatic and luxury cruise industry veteran Larry Pimentel, ceo of Azamara Club Cruises, will speak on *Winning on Social Media* and will also present one of the four Masterclasses during the conference, titled *Upselling - Selling Luxury and Expedition Cruises & Increase Your Revenue*.

CLIA head of international training and development Peter Kollar will present a Masterclass on *Myth-Busters - the changing landscape of River Cruising*, while another session will guide attendees in the successful implementation of a Plan a Cruise Month marketing campaign.

CLIA Australasia md Joel Katz said he was delighted the conference would feature both high calibre keynote speakers and local industry members.

Tickets are now available - more info at www.cruising.org.au.

Quark announces new World Explorer

QUARK Expeditions will expand its fleet for the 2018/19 season, with the addition of the luxury *World Explorer* - an all-suite, all-balcony vessel which will undertake ten voyages.

The ship has capacity for 176 guests and all staterooms have private bathrooms and "incredible exterior views".

World Explorer offers a dedicated spa area with an outdoor heated pool, a gym and sauna as well as a glass domed observation lounge.

The new program features an expanded Falklands & South Georgia itinerary, two special photography departures as well as Quark's "quintessential Antarctic adventures" - see www.quarkexpeditions.com/au.

Carnival Cup experts

CARNIVAL Cruise Line has confirmed that legendary race-caller Johnny Tapp will return to its Melbourne Cup cruise for the third year running this Nov, providing guests with "top tips to back a winner".

The voyage will also feature TV presenter Erica Davis from *Sydney Weekender* who will be joined by Melbourne stylist Trish G to provide fashion advice.

Passengers on the six-night round trip voyage from Sydney to Melbourne will also receive a General Admission ticket to the 2017 Emirates Melbourne Cup and Crown Oaks Day.

Vale John Duffy

CUNARD is mourning the death this week of John Duffy, the line's longest-serving senior officer.

Duffy, who was 73, was with the cruise line for 47 years until he retired five years ago, working as hotel manager aboard ships including *QE2* and *Queen Mary 2*.



OPEN 7 DAYS A WEEK

CruiseAgents is your premier independent cruise wholesaler located in Sydney CBD.

We specialise in cruise holiday packages and exclusive cruise tours!

Maximise your sales with CruiseAgents!

- ✓ Over 20 Cruise Lines
- ✓ No Registration Required
- ✓ No Hidden Fees
- ✓ Dedicated Team
- ✓ Easy Payment Options

CALL 1300 558 864
WWW.CRUISEAGENTS.TRAVEL

STAR CLIPPERS 2018/19 BROCHURE OUT NOW



STAR CLIPPERS
Unique Sailing Adventures

DISCOVER NOW >

CreativeCruising

1300 362 599

\$50,000* worth of **Gift Cards** to giveaway!

Click here >



MAKING TRAVEL SIMPLE



Jazz with Seabourn

SEABOURN will bring two jazz musicians aboard two select itineraries this northern autumn.

Guests will be able to listen to the music of Arturo Sandoval and John Pizzarelli on board *Seabourn Quest's* 05 Nov departure from Miami to Buenos Aires.

The duo will also perform on a 15 Nov Panama Canal sailing from Los Angeles on *Seabourn Sojourn*.

Bentours additions

BENTOURS has released two new 2018 Northern Lights tours including Hurtigruten sailings and is offering a \$250pp discount on the additions for bookings made by 15 Aug.

The 14-day Best of Norway + Iceland combines a rail journey with a six-night coastal cruise and is priced from \$6,000pp including the discount.

Bentours' new 17-day Norway + the Nordics includes a cruise south along the Norwegian coast.

Costa Sustainability

CARNIVAL Corporation's brand Costa Cruises has released its 2016 edition of the Sustainability Report "*Sea You Tomorrow – Rotta verso il futuro*".

The document highlights a 9.5% waste reduction per pax, a 5% carbon footprint reduction and a 3% reduction in fuel consumption per passenger per day on 2015.

The report outlines its strategy for sustainable development.

CLICK to view the full report.

Aqua wellness dep

AQUA Expeditions will host a four-night wellness departure on *Aqua Mekong* in Dec 2017.

The cruise is targeted at people wanting to stay physically and mentally balanced.

Led by fitness guru, Alex Salihin and departing Phnom Penh on 15 Dec, the cruise will explore Cambodian countryside.

Prices start from US\$5,140 per person twin-share.

Scenic Diamond in VR

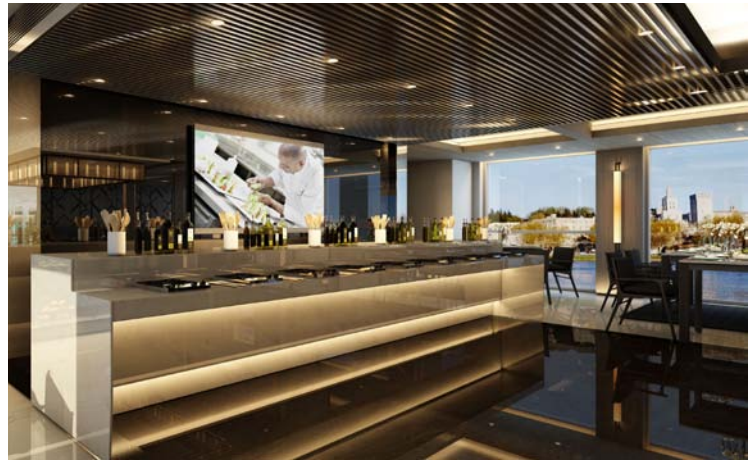

SCENIC guests are now able to take a look around the recently refurbished *Scenic Diamond* without stepping on board.

A new virtual reality tour of the vessel has been launched exploring its spaces.

Scenic's acting gm sales and marketing Liz Glover said the online video was "a wonderful tool for travel agents to use when selling river cruising".

"They will be able to show clients the various categories of suites available as well as check out the extensive on board facilities," she said.

During the refurbishment earlier this year *Scenic Diamond* introduced Scenic Culinaire, an on board cooking class (pictured above) and the first Salt Lounge on board a river cruise ship (below).

CLICK HERE to take the tour.

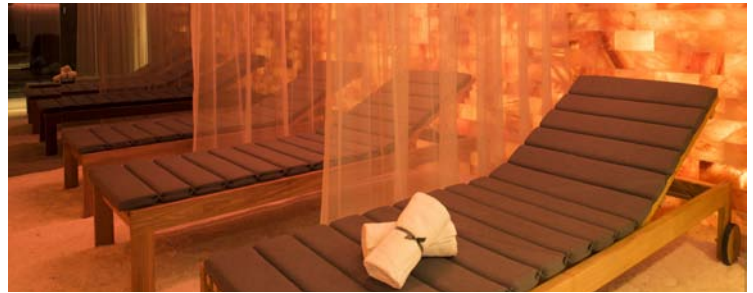

Register with Princess Academy and complete the Introducing O•C•E•A•N™ module by 11.59 AEST 4TH of August, 2017 for a chance to win an Ocean Medallion Cruise™ to the Caribbean!

MAJOR PRIZE

7-night Ocean Medallion™ Western Caribbean Princess Cruise for 2 in a Balcony Stateroom on Regal Princess® & a AUD\$4500 EZair® credit voucher.

MINOR PRIZE

Win one of 5 AUD\$100 visa gift cards

REGISTER TODAY: www.onesourcecruises.com

**PRINCESS
ACADEMY**

Register to relax...



The Caribbean is calling you to register with Academy.

Terms and Conditions apply, click through for details. Open to AU & NZ res. 18+ who are either employed as a travel agent by a WLCL registered travel agency in AU or NZ or are the owner/manager of a travel agency eligible for WLCL registration in AU or NZ. Must not be already registered with the Princess Academy Program as at 2/7/17. Starts: 3/7/17. Ends: 11:59pm AEST 4/8/17. Limit 1 entry per person. Draw: 55, Erina Plaza, 210 Central Coast Hwy, Erina NSW 2250 on 15/8/17 at 12pm AEST. Winners at www.onesourcecruises.com from 21/8/17. Major Prize: 7 night Western Caribbean cruise for 2 valued at \$3,588 + \$4,500 EZair flight voucher toward airfares. Prize must be taken to coincide with the cruise's departure on 3/12/17. Minor Prizes: 5 x \$100 Visa Gift Card. Promoter: Carnival plc trading as Princess Cruises (ABN 23 107 998 443) of L5, 15 Mount St, North Sydney, NSW 2060 (in AU) and Carnival plc trading as Princess Cruises (Company No. 1471215) of Level 7, Chorus House, 66 Wyndham Street, Auckland 1010 (in NZ). Permits: NSW LTPS/17/14320, ACT TP17/00951, SA T17/892.



Do you have the *Cruise Weekly* app?

CRUISE WEEKLY



AQSC hotel chief

AMERICAN Queen Steamboat Co has recruited Nicola Volpe as its new vice president of hotels.

Volpe joins the line from Prestige Cruise Holdings, where he was director of newbuilds and hotel operations, helping launch *Regent Seven Seas Explorer*.

PORTHOLE



THERE'S been an exciting rescue at sea this week, with the Sri Lankan Navy saving the life of an elephant which had been washed out to sea.

The pitiful pachyderm was spotted about 8km offshore trying to stay afloat, and after authorities were alerted the military was scrambled and mounted a 12 hour operation aided by wildlife officials.

Divers attached ropes to the distressed beast (pictured) and a fast attack boat gently towed it towards the shore where it was released late on Tue this week.

"It is a miraculous escape for the elephant," said spokesman Chaminda Walakuluge.

He said the creature had probably been swept into the ocean while crossing the Kokkilai lagoon, a large stretch of water between two areas of jungle.



More Ponant keels laid



PONANT Cruises' newest 'explorer' ships came one step closer this week, with the formal keel laying ceremony for *Le Bougainville* and *Le Dumont-d'Urville* in Norway.

The third and fourth vessels in the series are now under construction in one of the shipyards of Vard, the Norwegian offshoot of Fincantieri.

The first two yachts, *Le Laperouse* and *Le Champlain* are scheduled for delivery in less than a year's time, with these latest two set to hand over in Jun 2019.

Ponant's new generation of

ships, sailing under the French flag, will feature 92 cabins and suites and boast cutting edge "Cleanship" equipment in compliance with the latest environmental regulations.

Built to be able to drop anchor in the most inaccessible sites, the Ponant Explorers will be able to offer "an ever-wider range of destinations" - notably tropical and sub-tropical regions such as Costa Rica, the Amazon, the Maldives, Papua New Guinea, the Orinoco and the Bissagos Islands.

All four Ponant Explorers will also feature the world first Blue Eye "multi sensorial underwater lounge" (CW 01 Jun).

The construction crew are pictured at the keel laying with Ponant newbuilding chief engineer, Hugues Decamus.

Cake by the Ocean?

ROYAL Caribbean International will host pop star Joe Jonas and his band DNCE aboard the upcoming 'Total Eclipse Cruise' on *Oasis of the Seas*.

The group will perform during an exclusive on board party on 21 Aug (CW 06 Jun), during which the ship will be positioned for the "vantage point of the century" to view the moment the moon masks the sun for a few minutes of total darkness.

Chimu earlybird

CHIMU Adventures is offering savings of up to 50% on selected 2018/19 Antarctica departures.

Prices lead in at \$8,300 (single cabin) for an 11-day itinerary, with deals valid for bookings by 30 Sep - chimuadventures.com.



Port Development

ACA has long held the view that regional ports are critical to the growth of the Australian cruise industry. It was therefore exciting to hear the news this week that the ports of Eden in the south and Cairns in the north are to receive assistance with their port infrastructure development.

The Port of Eden has received final approval for a \$44m upgrade (CW Tue) which will enable larger cruise ships to berth at their wharf facility. This is great news for Eden which hopes to increase its visits to 40-60 cruise ships annually.

It is also great news for the broader region. Anthony Osborne, EO of Sapphire Coast Tourism told ACA that he sees the upgrade as an opportunity to create long term sustainability for the area as a cruise destination. Additionally he sees it as a catalyst for investment and industry development across all tourism sectors.

This reinforces ACA's view that cruising and destination development go hand in hand & this is certainly also the case in Cairns.

Ports North's \$120m Cairns Shipping Development Project which is being backed by the Queensland Government, will greatly expand the current terminal facilities positioning Cairns to take advantage of the state's growing cruise sector.

The project is slated to create economic growth through employment, investment by adjacent businesses and of course the tourism dollars which will come from increasing cruise pax numbers.

Project updates will be provided at the ACA conference in Sep.